

MANUALE
TECNICO

F68M

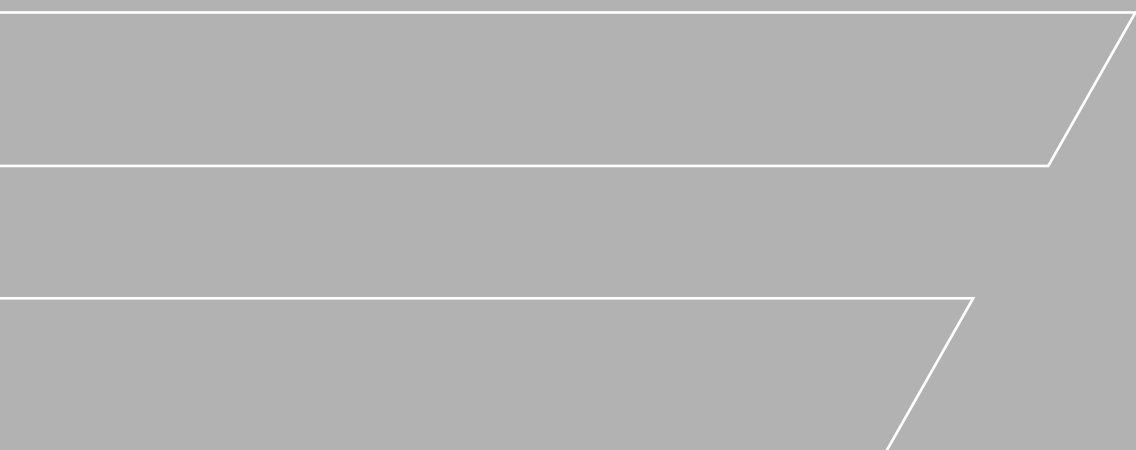

CAPITOLATO

Finestre e portefinestre per esterni, realizzate mediante profili in legno lamellare, conforme alla Classe D4 per la resistenza delle linee di colla, secondo le normative previste. Sezione Telaio spessore 68x80 mm e sezione dell'anta 68x87 mm. I profili sono uniti mediante spine cilindriche in legno per garantire una maggiore stabilità e superficie d'incollaggio a finestra assemblata. Traverso inferiore con gocciolatoio in alluminio rivestito in legno. Cornici di serie interne 60x13 esterne 33x10 realizzate in legno massello. Guarnizioni di tenuta montate a doppio anello con soluzione di continuità sia su telaio fisso che su telaio mobile, in gomma termoplastica a norme UNI 8649 contenenti magneti naturali permanenti. Tali guarnizioni, in funzione della loro reciproca attrazione, tra anello fisso e anello mobile, permettono una tenuta termoacustica ed idropneumatica illimitata. Ferramenta per la movimentazione ed apertura delle ante realizzata in acciaio e zinco pressofuso con successivo trattamento di zincatura e passivazione secondo norme DIN 50941. Tutti i componenti vengono successivamente provvisti di uno strato di cera che aumenta la protezione anticorrosione e la scorrevolezza dei singoli pezzi. Di serie apertura a ribalta con dispositivo di microventilazione. La ferramenta di portata è realizzata con cerniere regolabili tridimensionalmente per una perfetta registrazione, già comprese di coperture con guaine plastiche in vari colori. Vetrocamera da 28mm, realizzato con lastre di vetro semplici o accoppiate, unite da distanziale in alluminio. Le lastre possono essere basso emissive e nella camera può essere inserito gas argon e impiegate canaline a bordo caldo per migliorare le prestazioni termiche. La verniciatura viene realizzata in modo completamente naturale all'acqua, mediante impregnazione a flow coating, fondo a spruzzo, carteggiatura e verniciatura finale sempre a spruzzo.



F68M

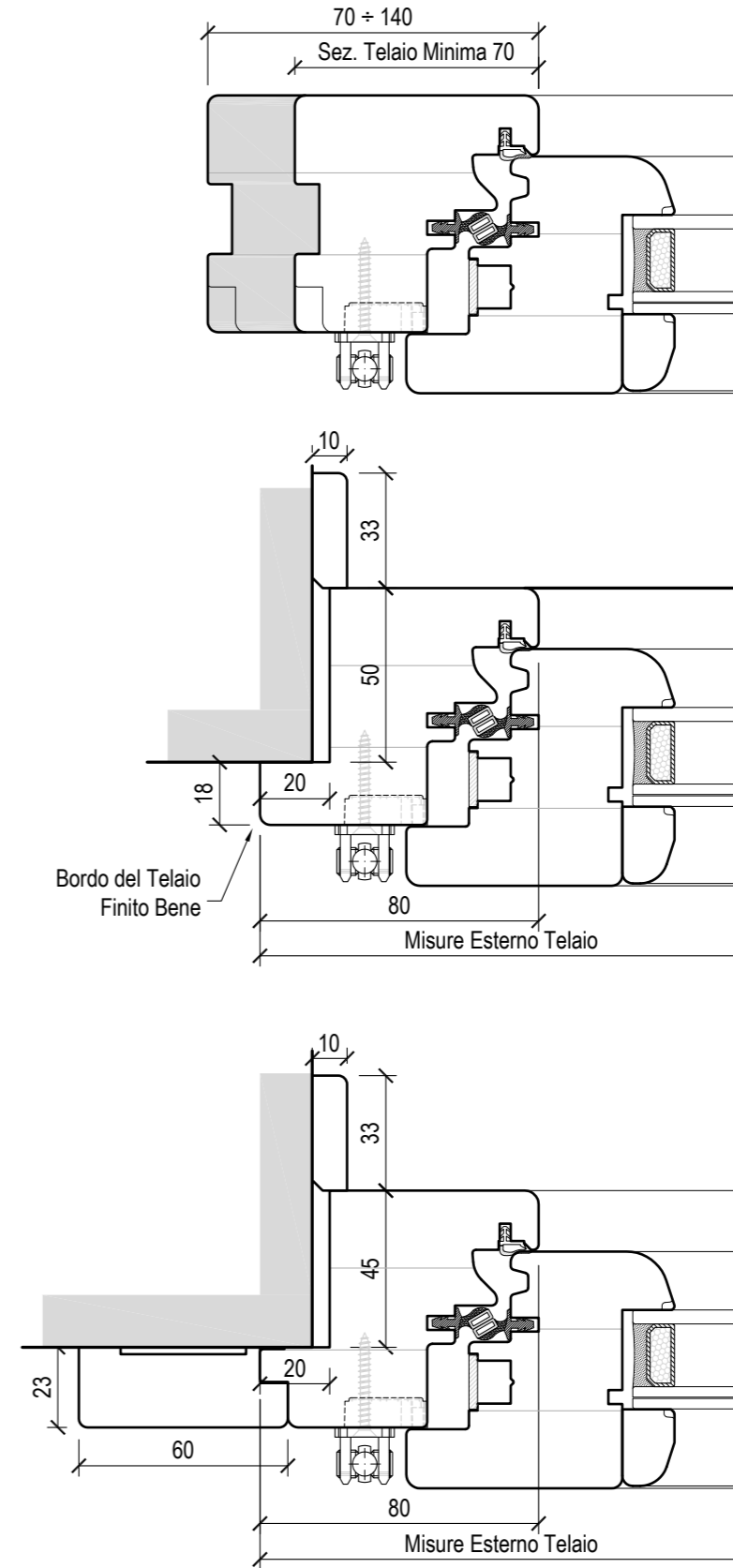
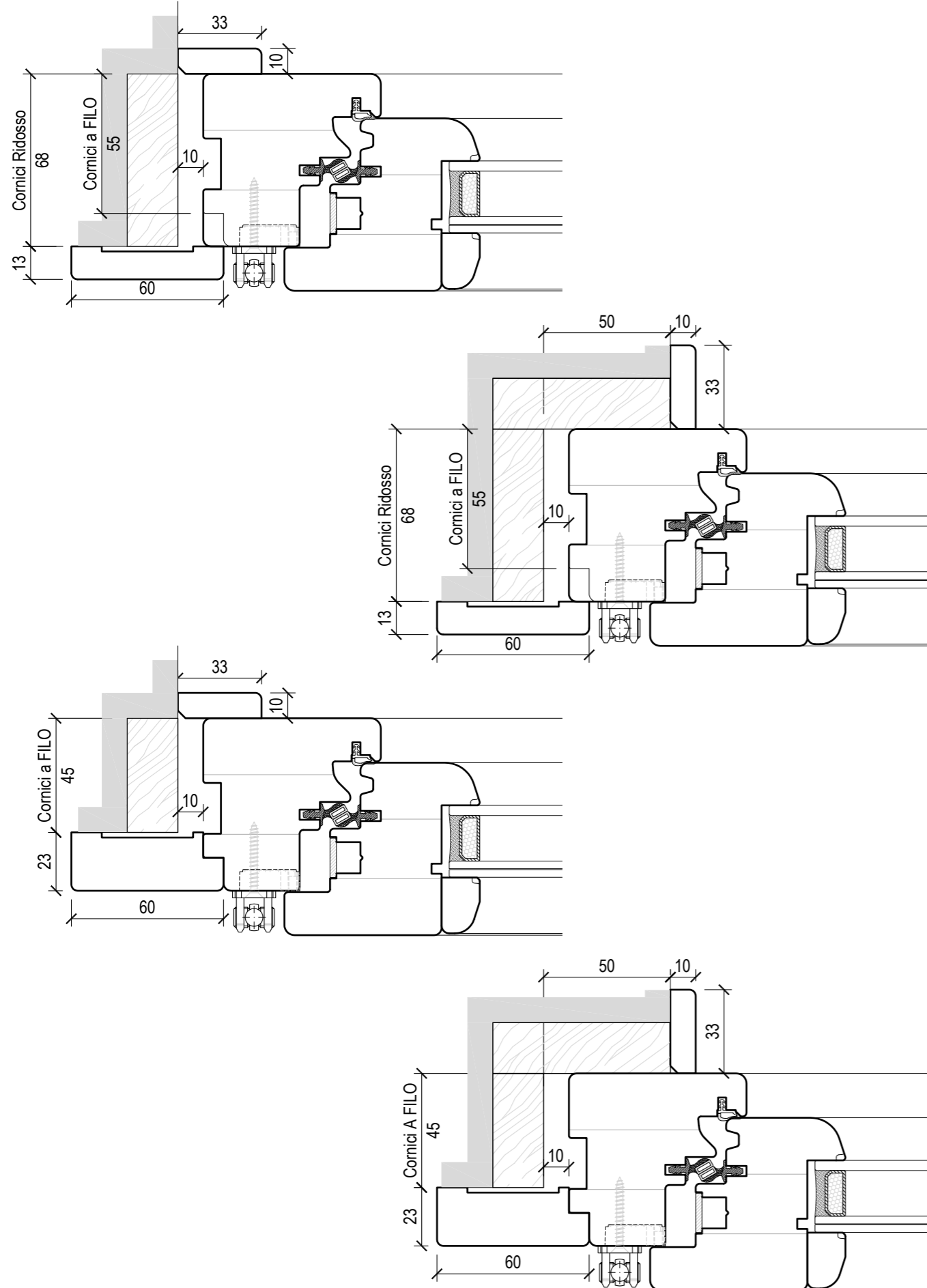

N.B. Le soluzioni sopra rappresentate sono alcuni esempi di situazioni che si possono verificare in cantiere.
È possibile studiare soluzioni differenti, con supporto dell'ufficio tecnico/commerciale.

FALSO TELAIO DRITTO

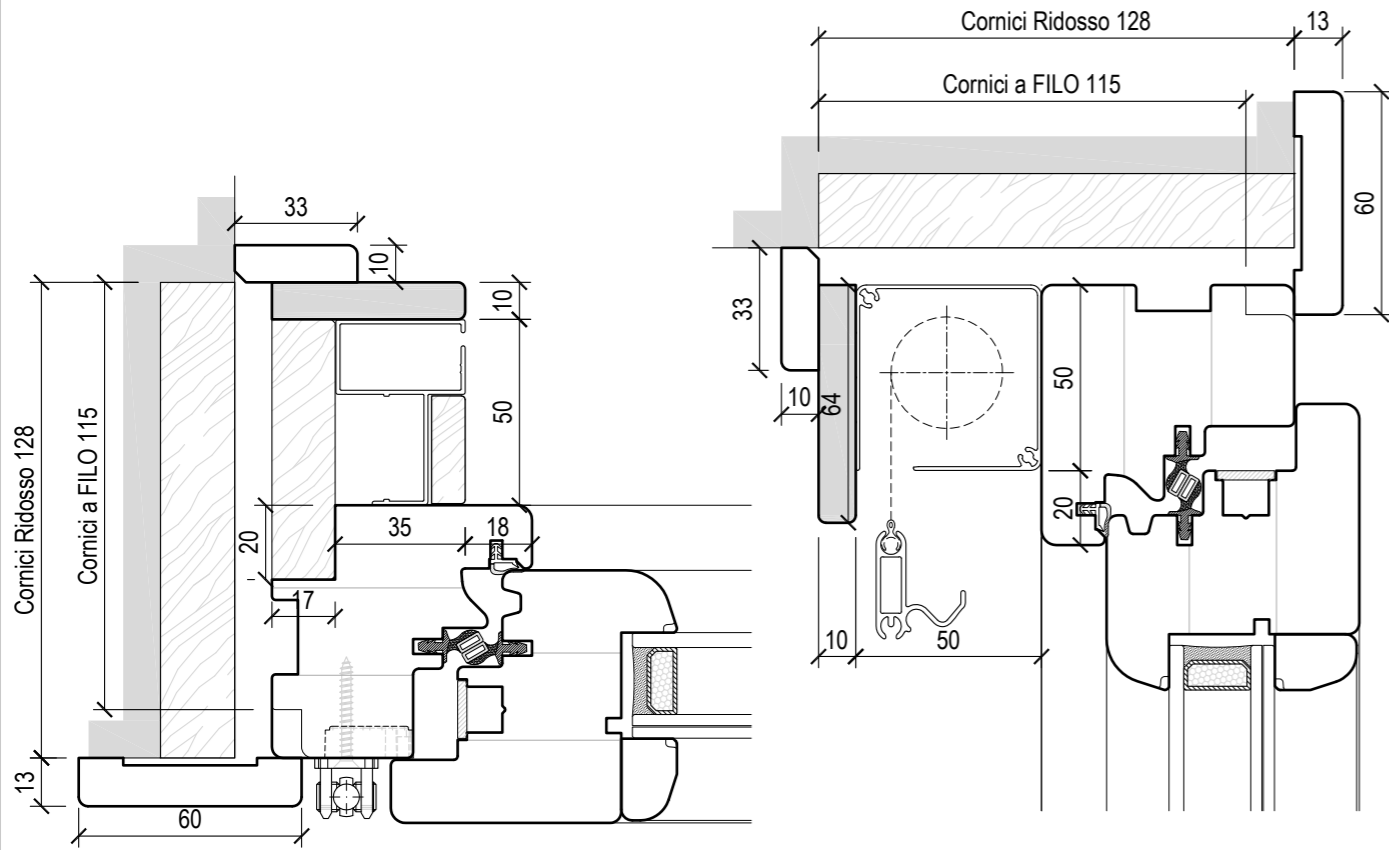

FALSO TELAIO AD "L"

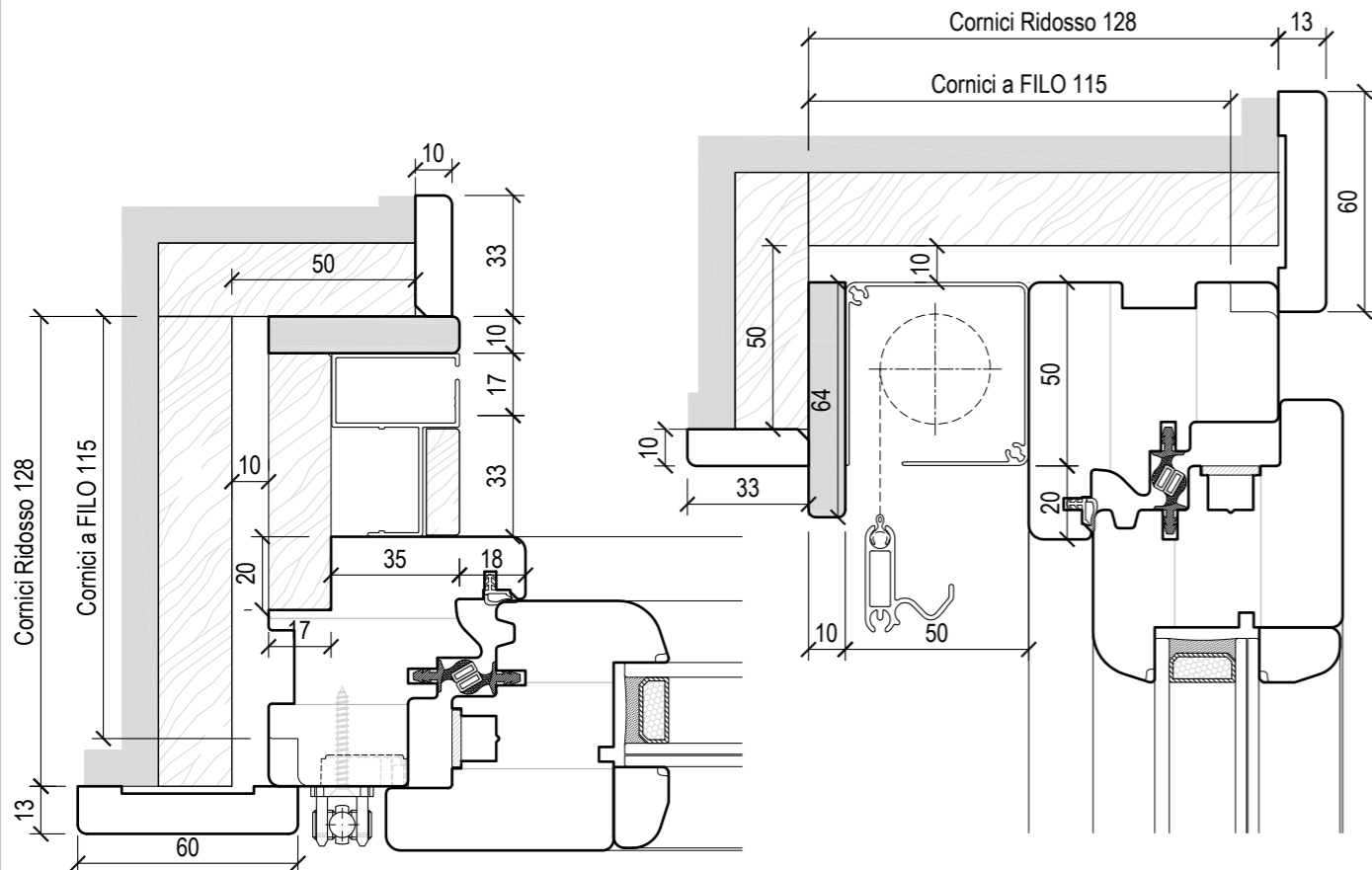

MONOBLOCCO A CENTRO MURO

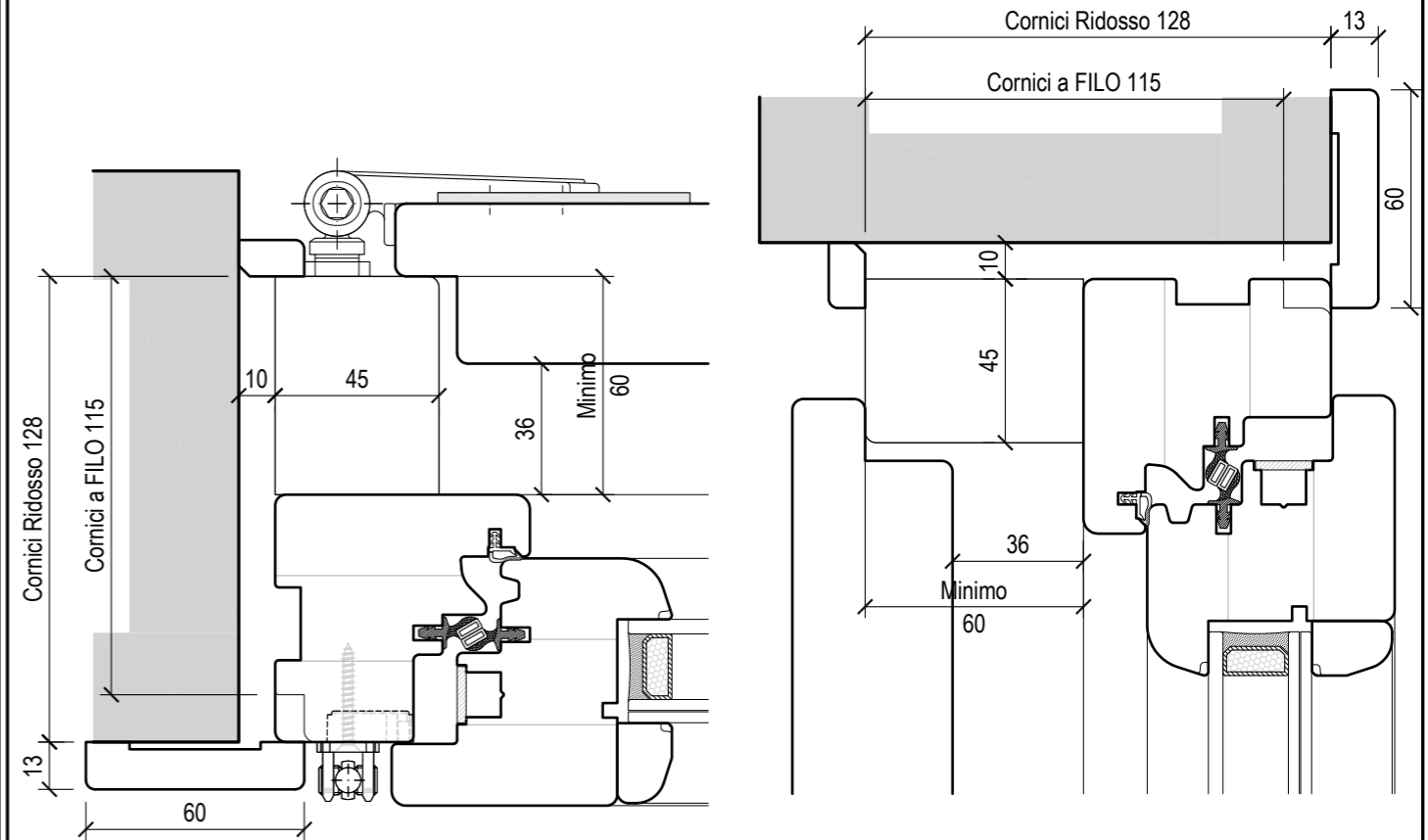

MONOBLOCCO A FILO MURO ESTERNO

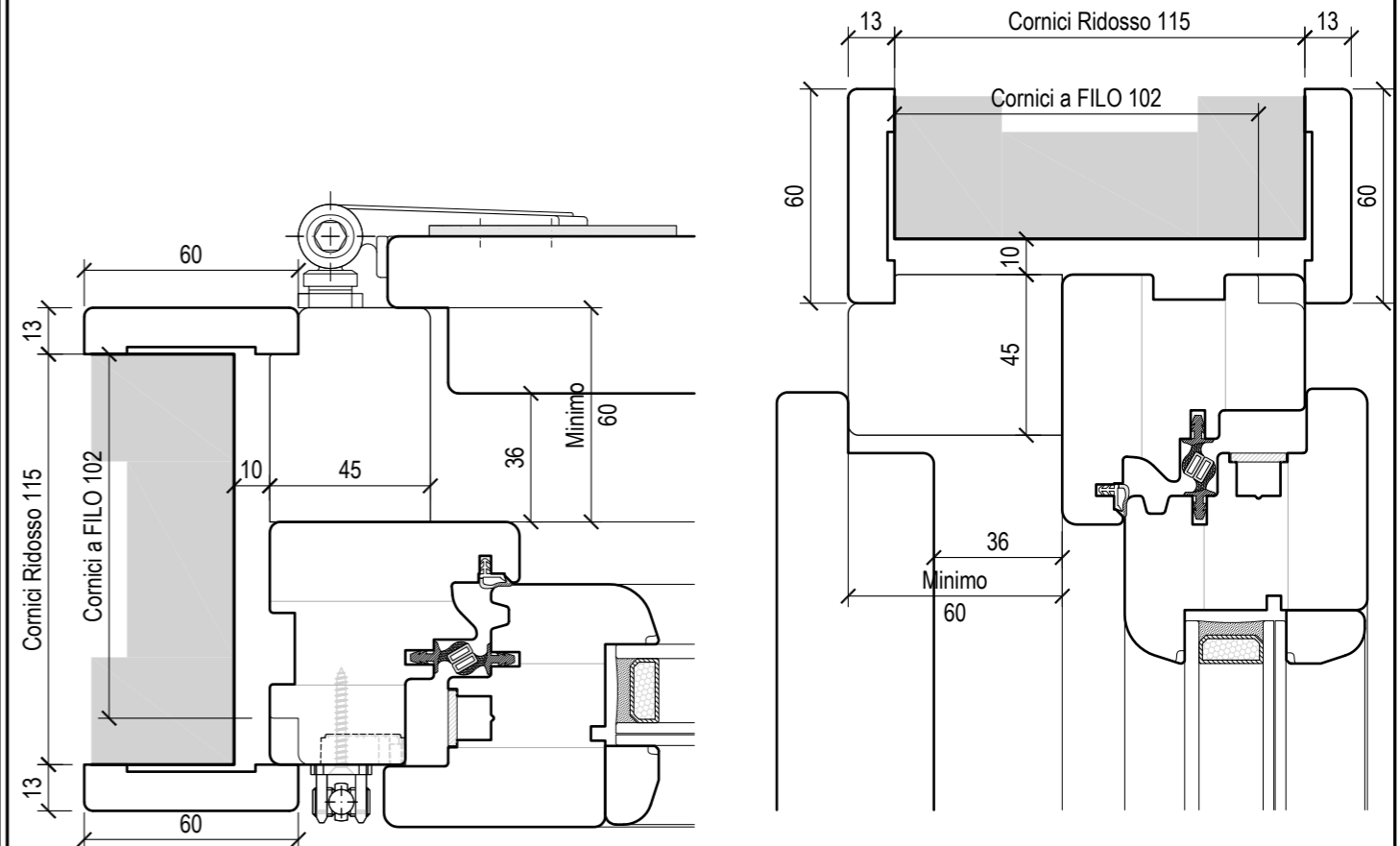

N.B. In presenza di scuro con Mottura l'imbotte va ulteriormente ringrossato di 30mm

MONOBLOCCO A CENTRO MURO

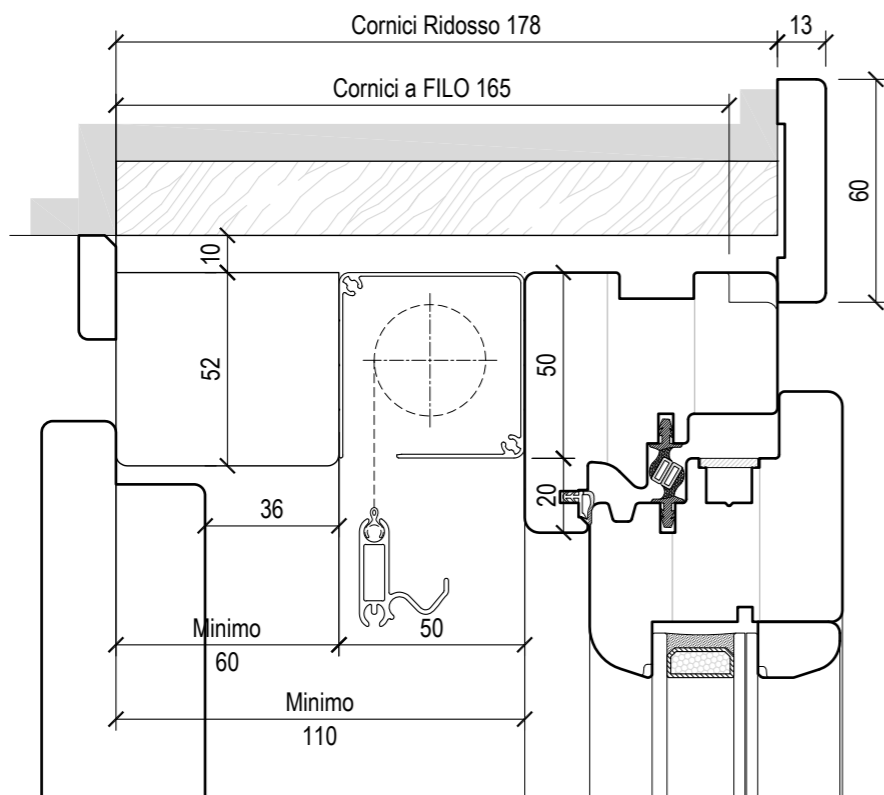
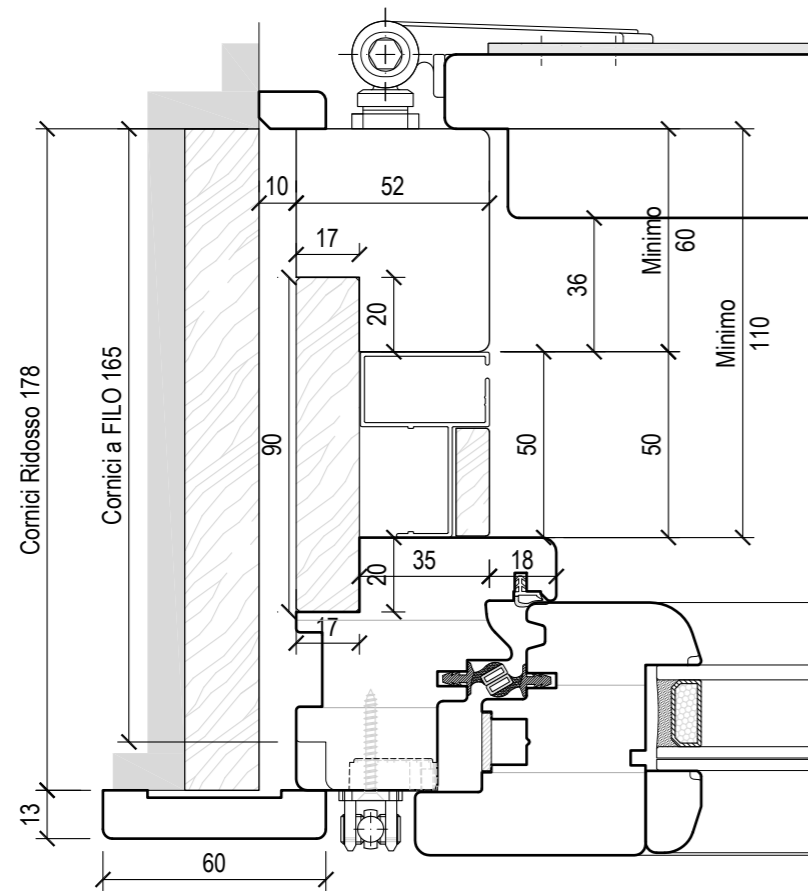

N.B. In presenza di scuro con Mottura l'imbotte va ulteriormente ringrossato di 30mm

MONOBLOCCO A FILO MURO ESTERNO

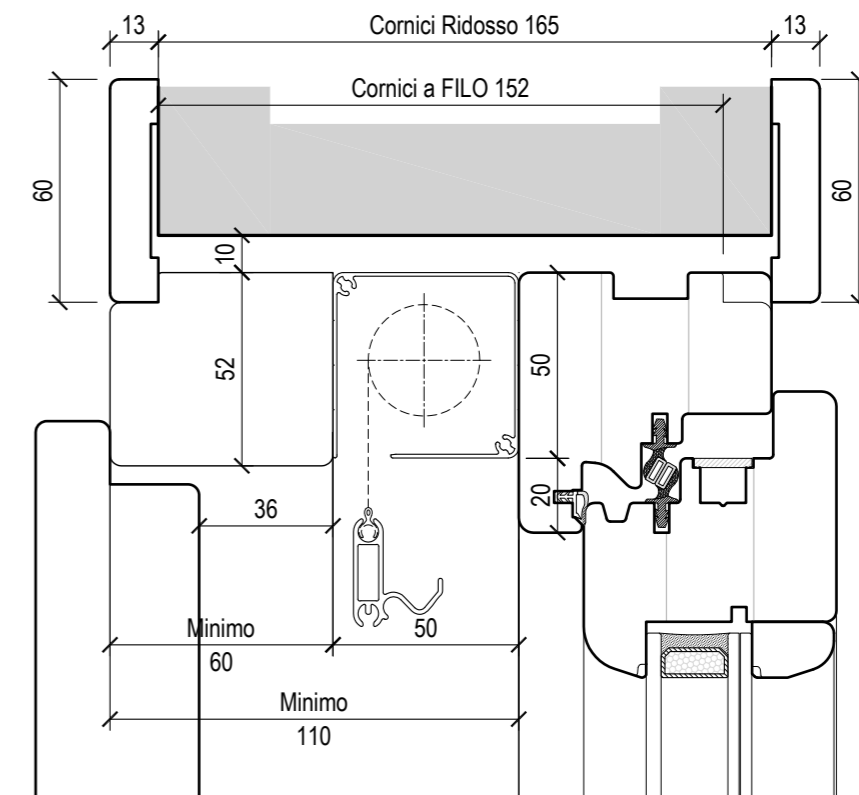
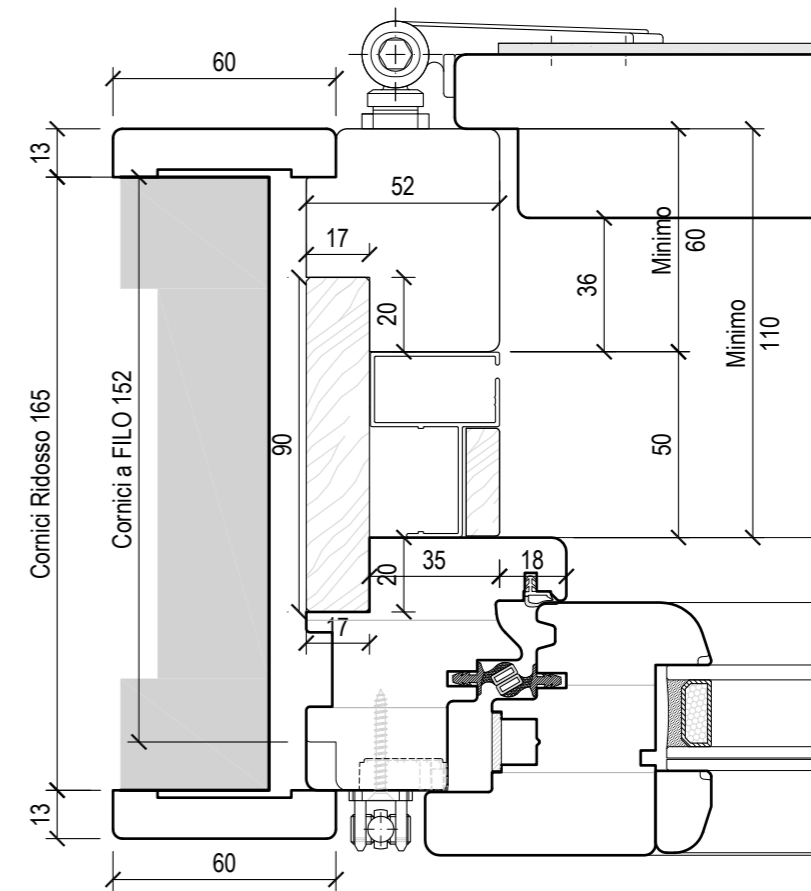

N.B. In presenza di scuro con Mottura l'imbotte va ulteriormente ringrossato di 30mm

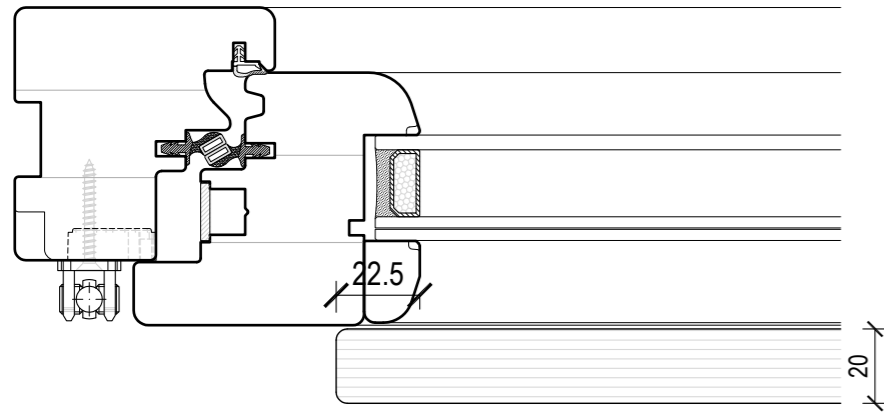

SCURETTO INTERNO
MOD.PANNELLO LISCIO
(Valido x Tutte le tipologie di
Fermavetro)

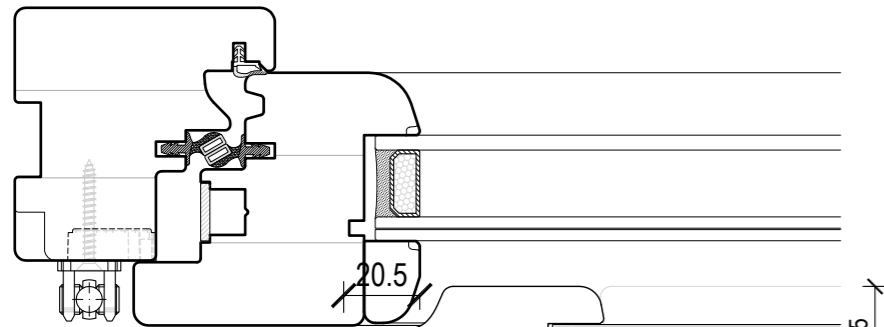

SCURETTO INTERNO
MOD.INTELAIATO LISCIO

Sagoma Telaietto
SCURETTO
INTELAIATO
su Fermavetro Sagomato
Fermavetro Squadrato

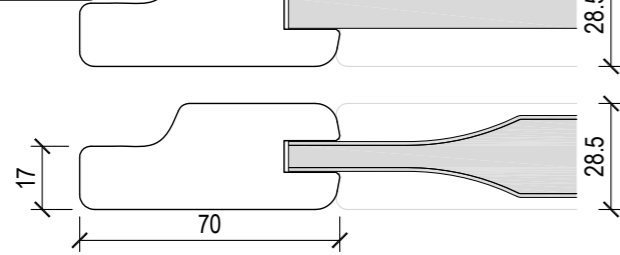

SCURETTO INTERNO
MOD.INTELAIATO BUGNATO

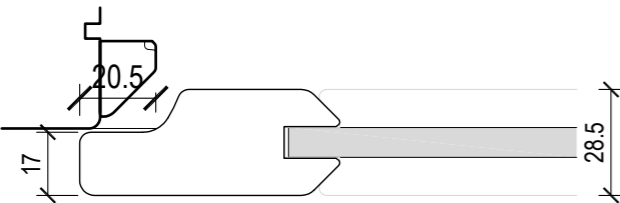

SCURETTO INTERNO
MOD.INTELAIATO LISCIO

Sagoma Telaietto
SCURETTO
INTELAIATO
su Fermavetro Diamante

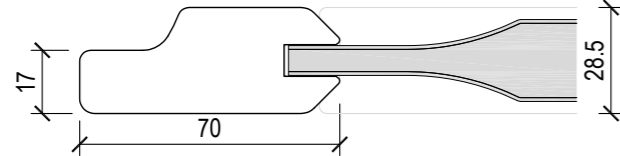

SCURETTO INTERNO
MOD.INTELAIATO BUGNATO

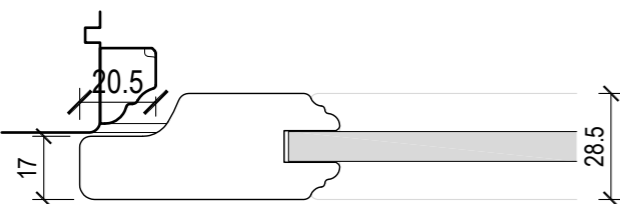

SCURETTO INTERNO
MOD.INTELAIATO LISCIO

Sagoma Telaietto
SCURETTO
INTELAIATO
su Fermavetro Barocco

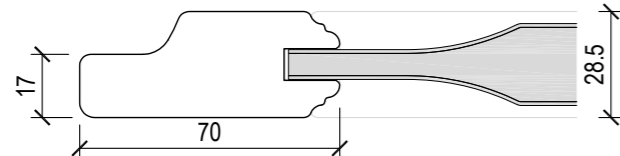

SCURETTO INTERNO
MOD.INTELAIATO BUGNATO

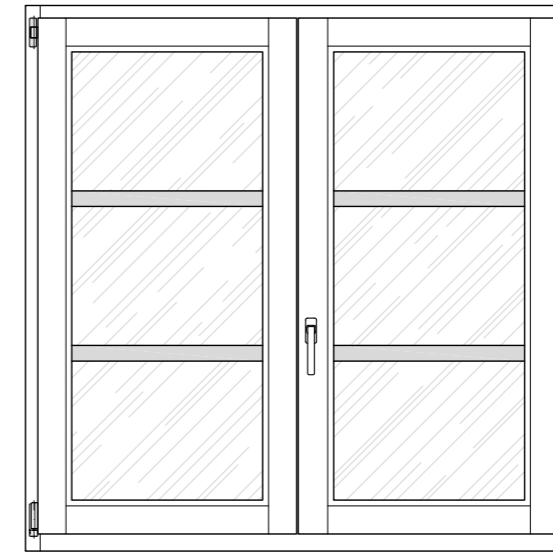

Fuseruolo
DIAMANTE Alternativa

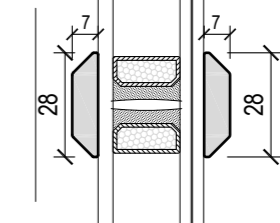

Fuseruolo
BAROCCO Alternativa

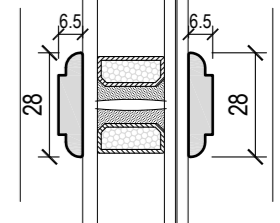

Soluzione Standard
FV Squadrato

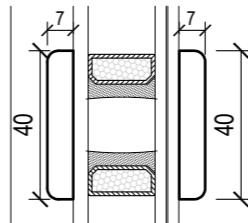

Soluzione Standard
FV Sagomato

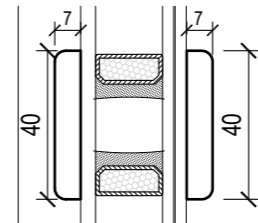

Soluzione Standard
FV Diamante

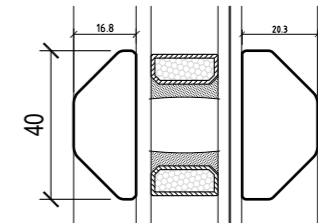

Soluzione Standard
FV Barocco

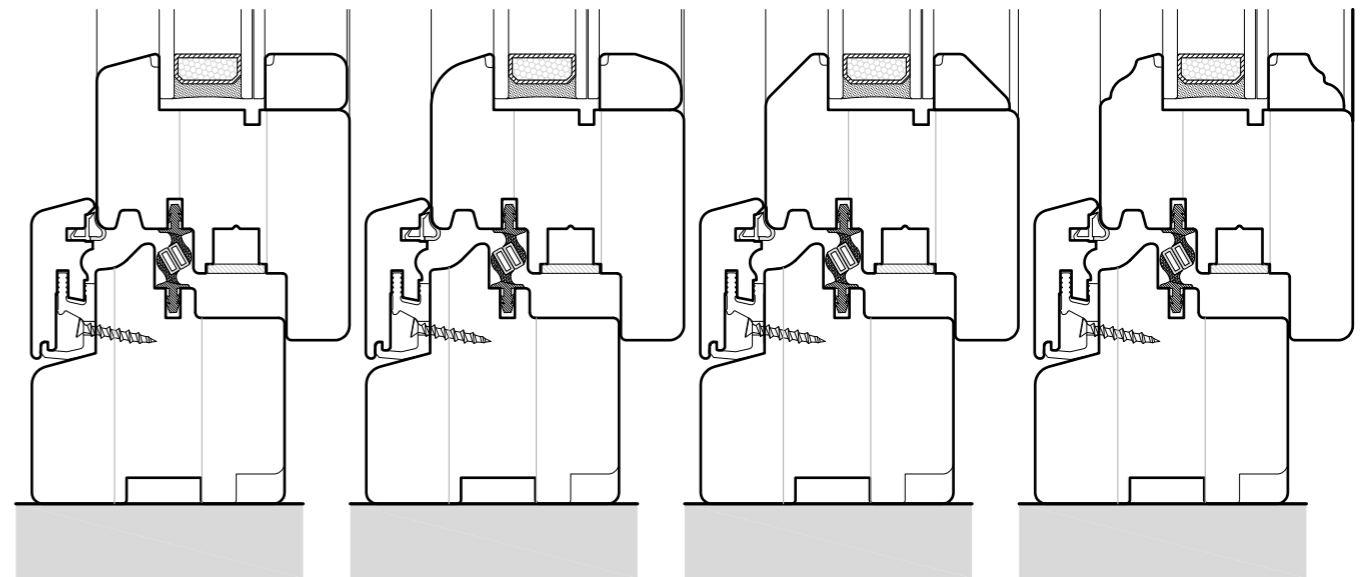
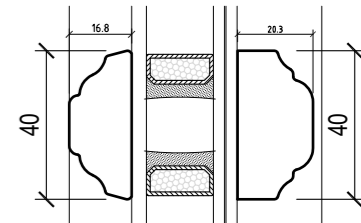

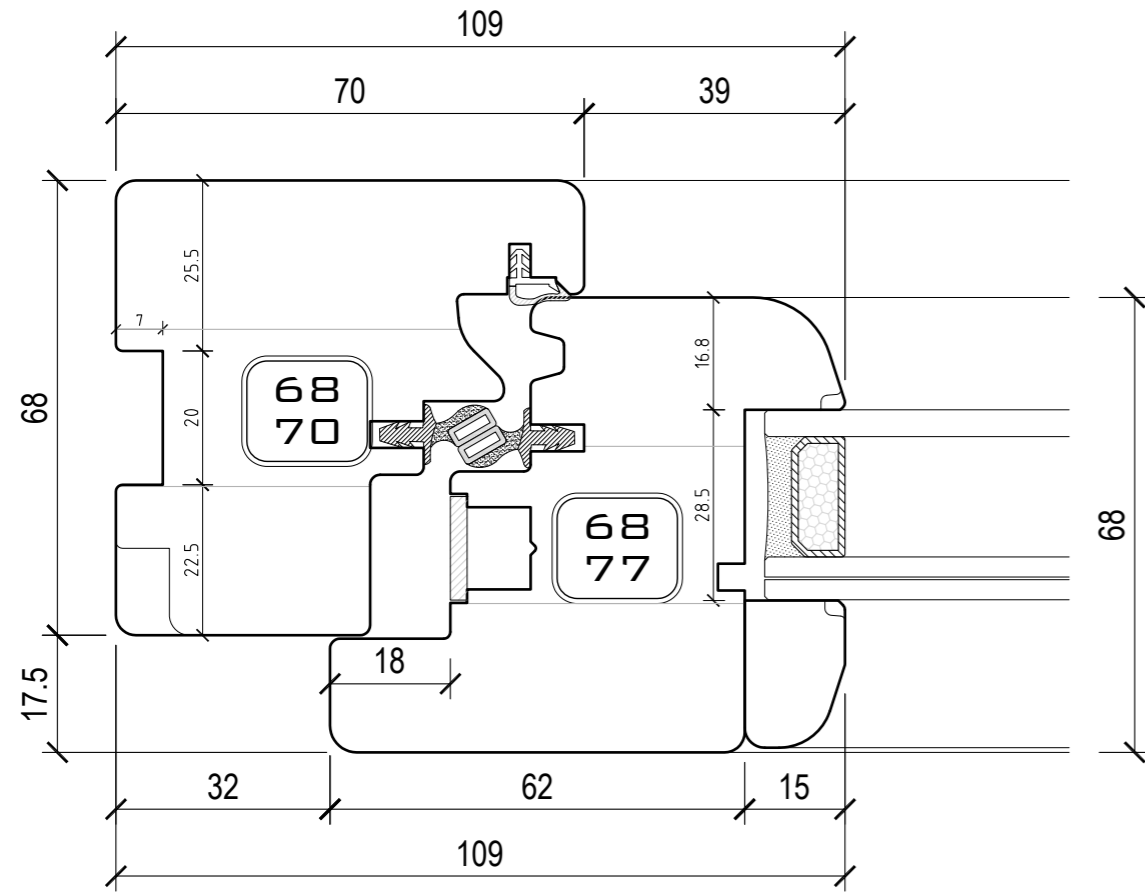

SCELTA TIPO FERMAVETRO

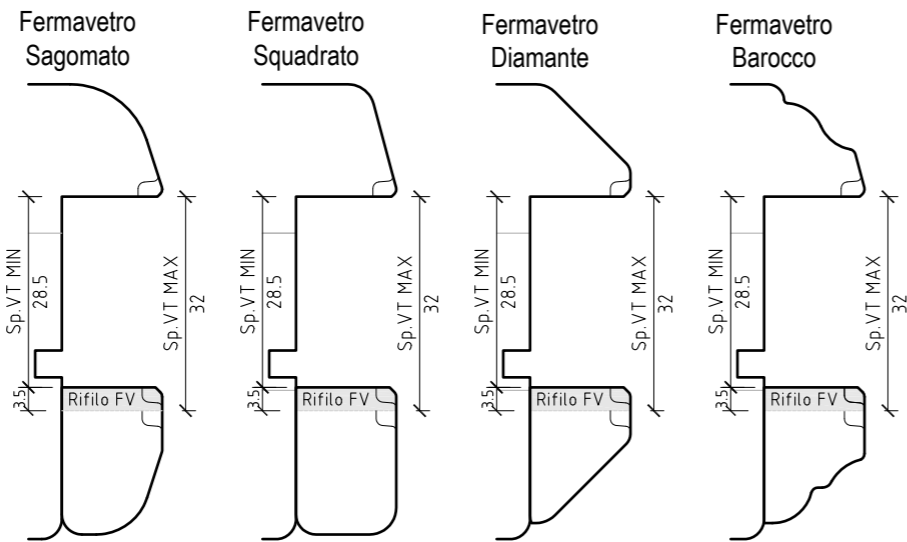

VISTA INTERNA

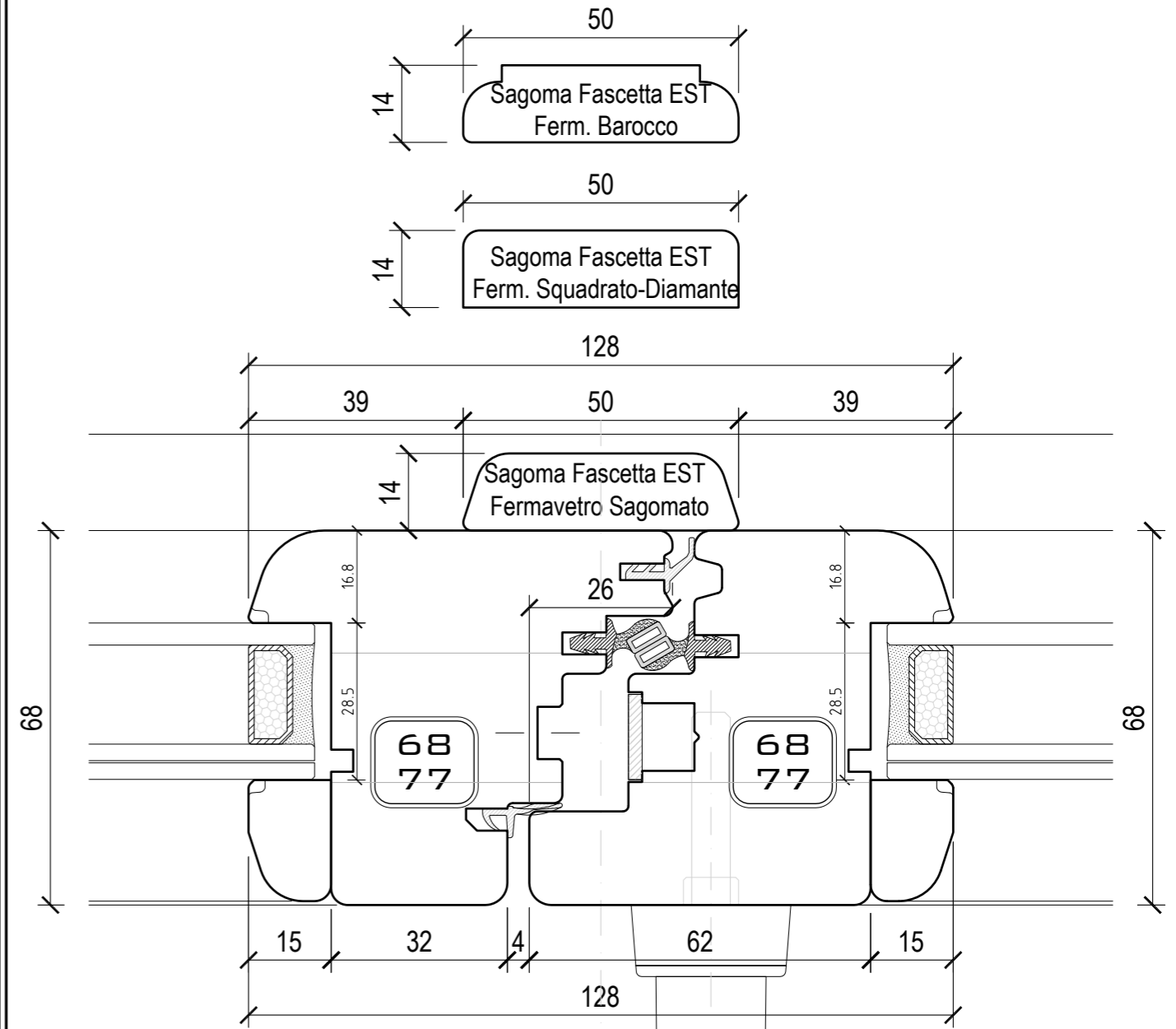
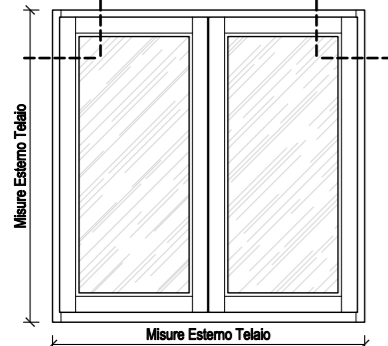

SCELTA TIPO FERMAVETRO

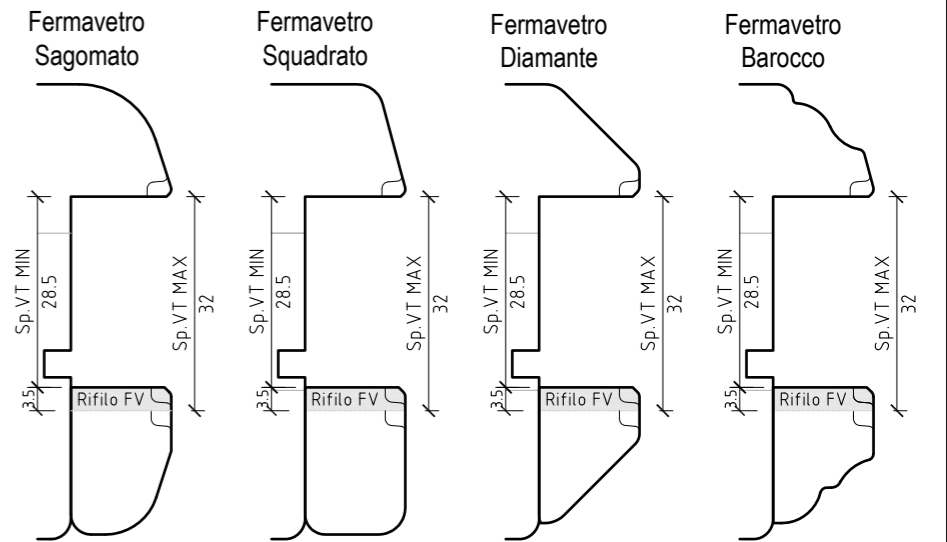

VISTA INTERNA

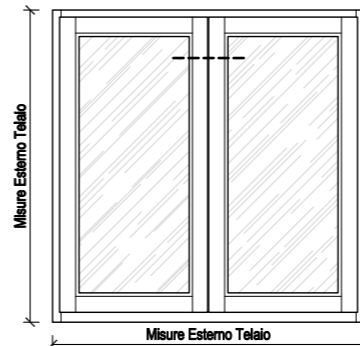

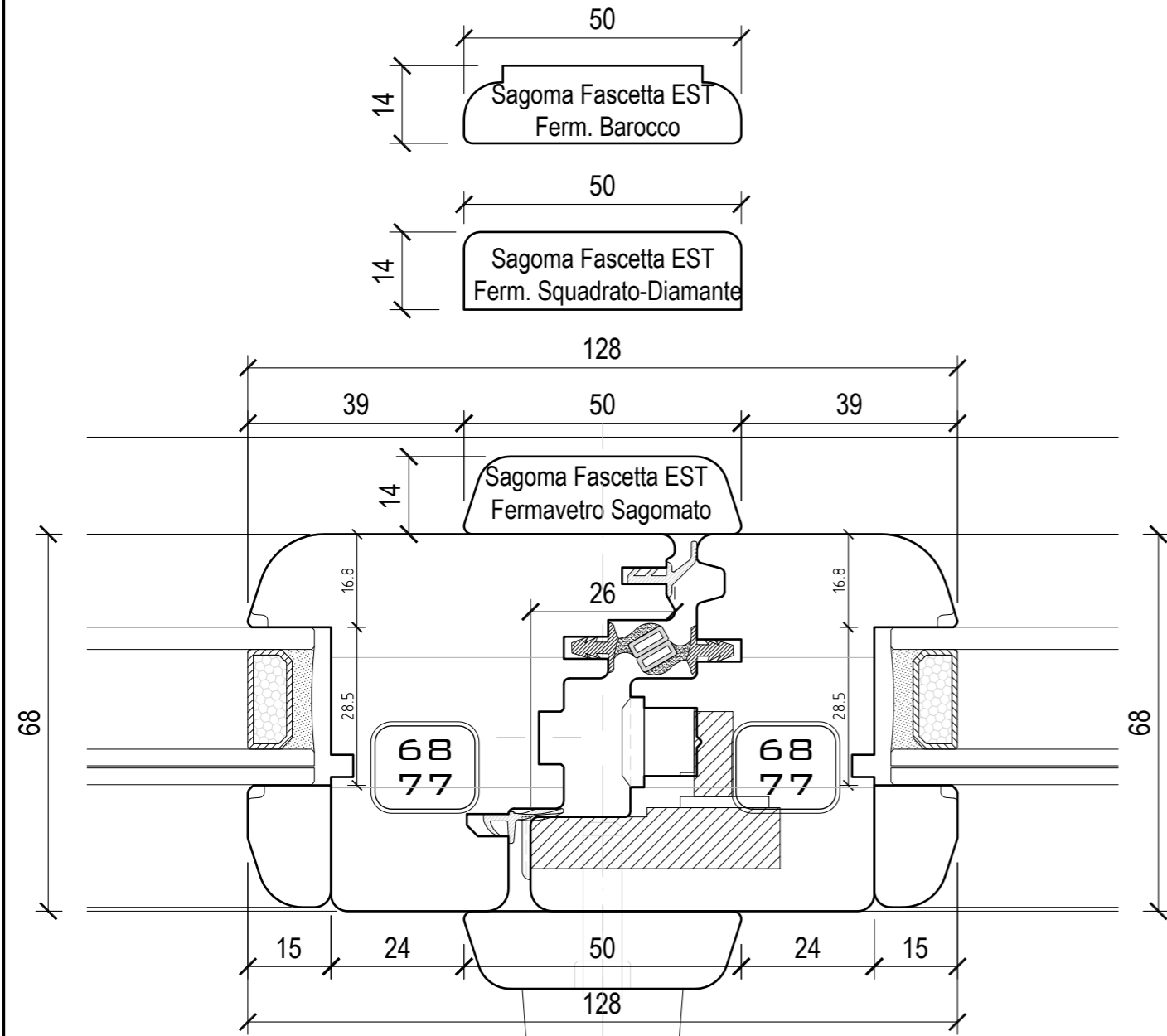

SCELTA TIPO FERMAVETRO

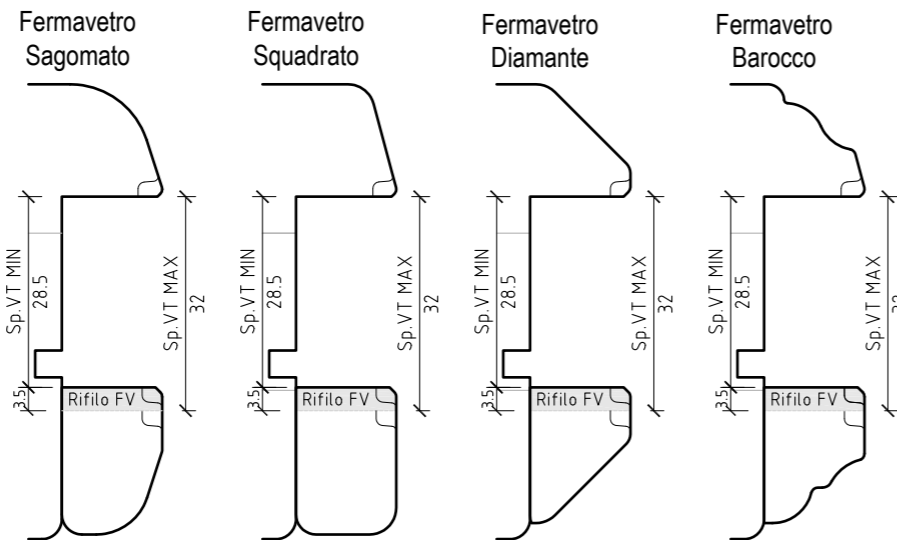

VISTA INTERNA

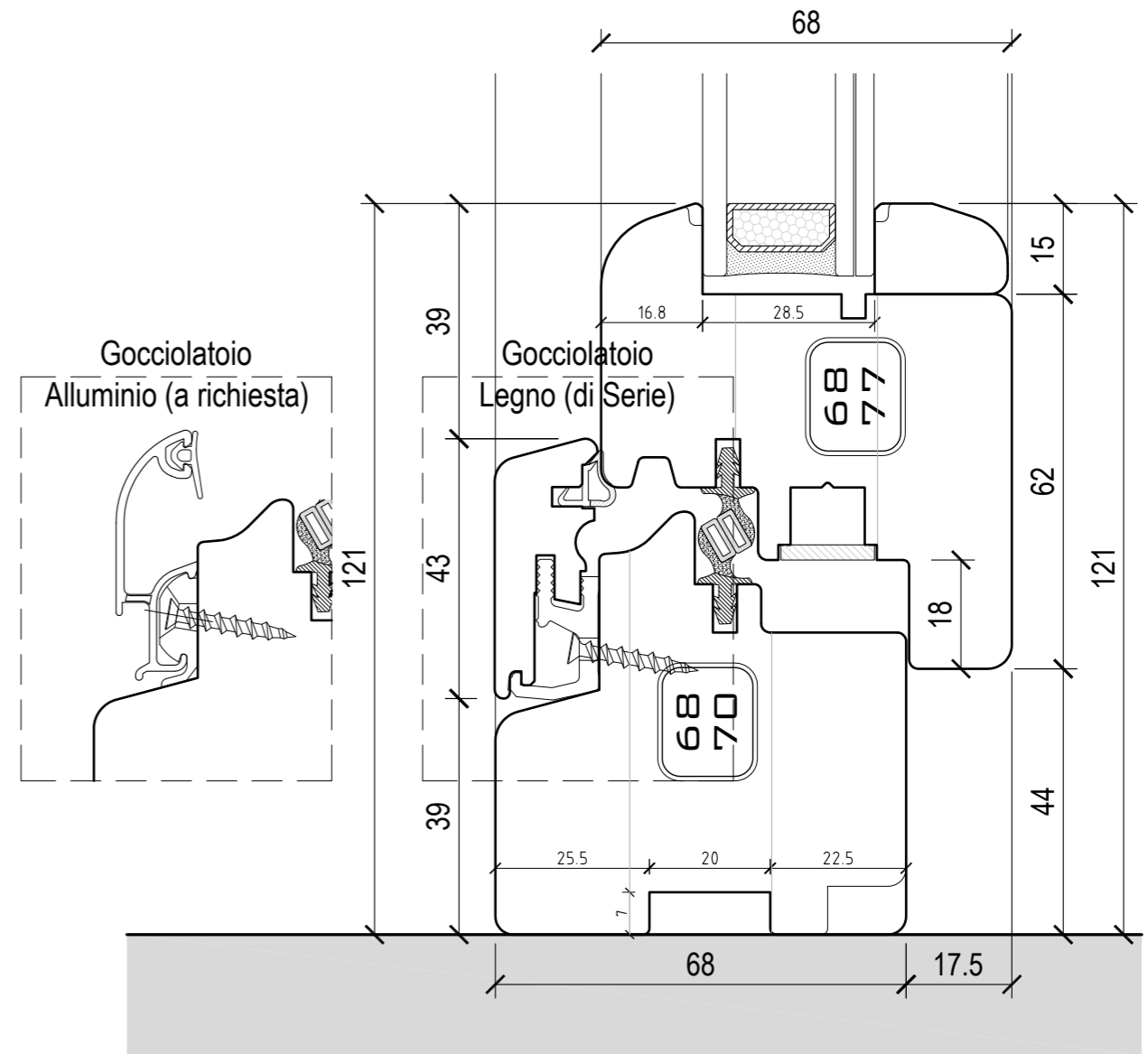

SCELTA TIPO FERMAVETRO

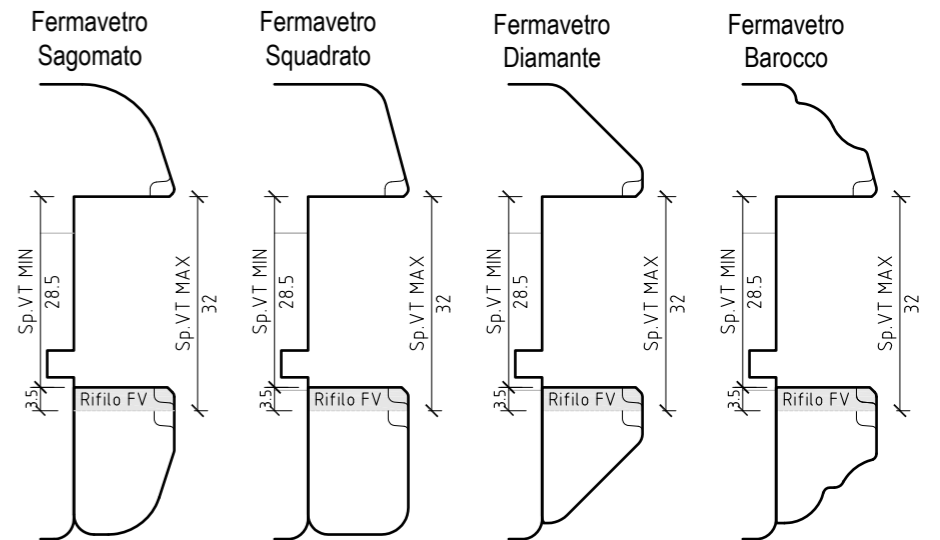

VISTA INTERNA

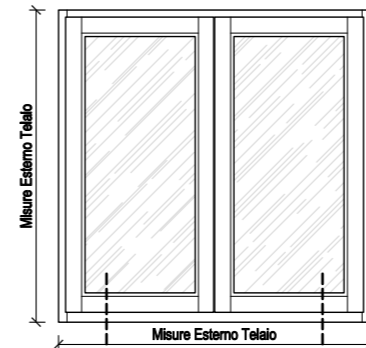

SCELTA TIPO FERMAVETRO

Fermavetro Sagomato

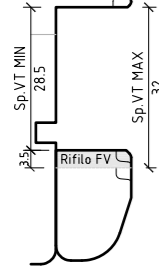

Fermavetro Squadrato

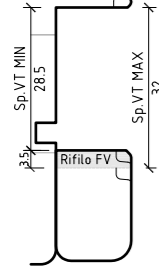

Fermavetro Diamante

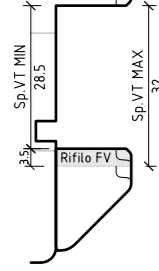

Fermavetro Barocco

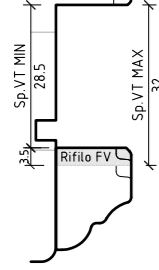

VISTA INTERNA

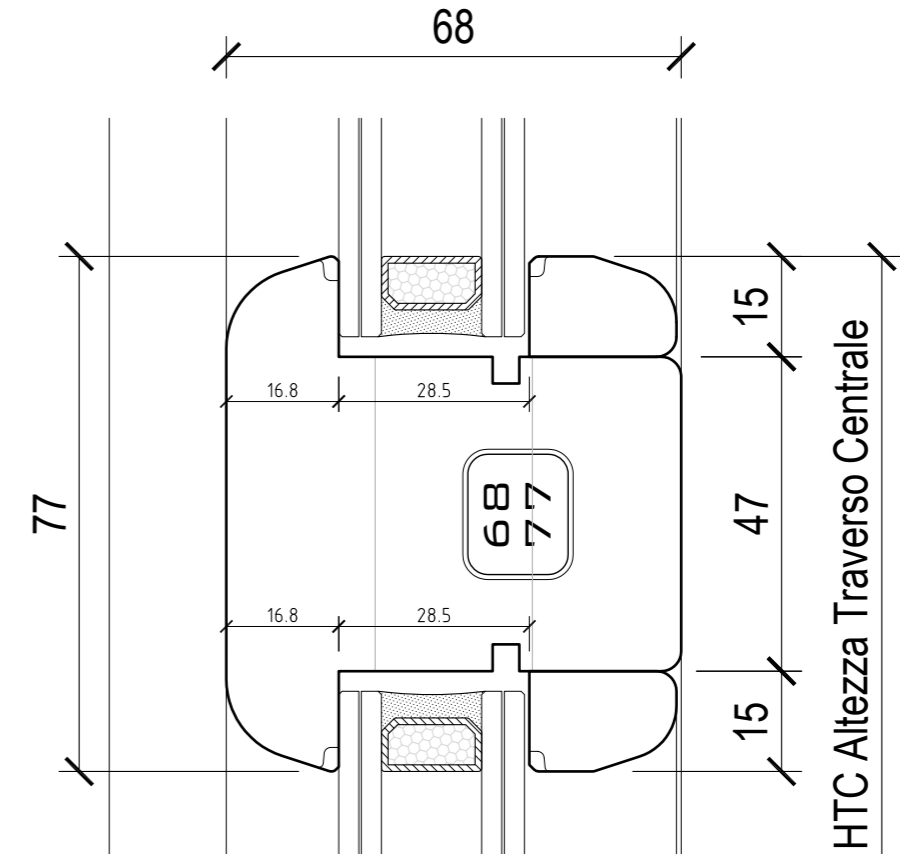
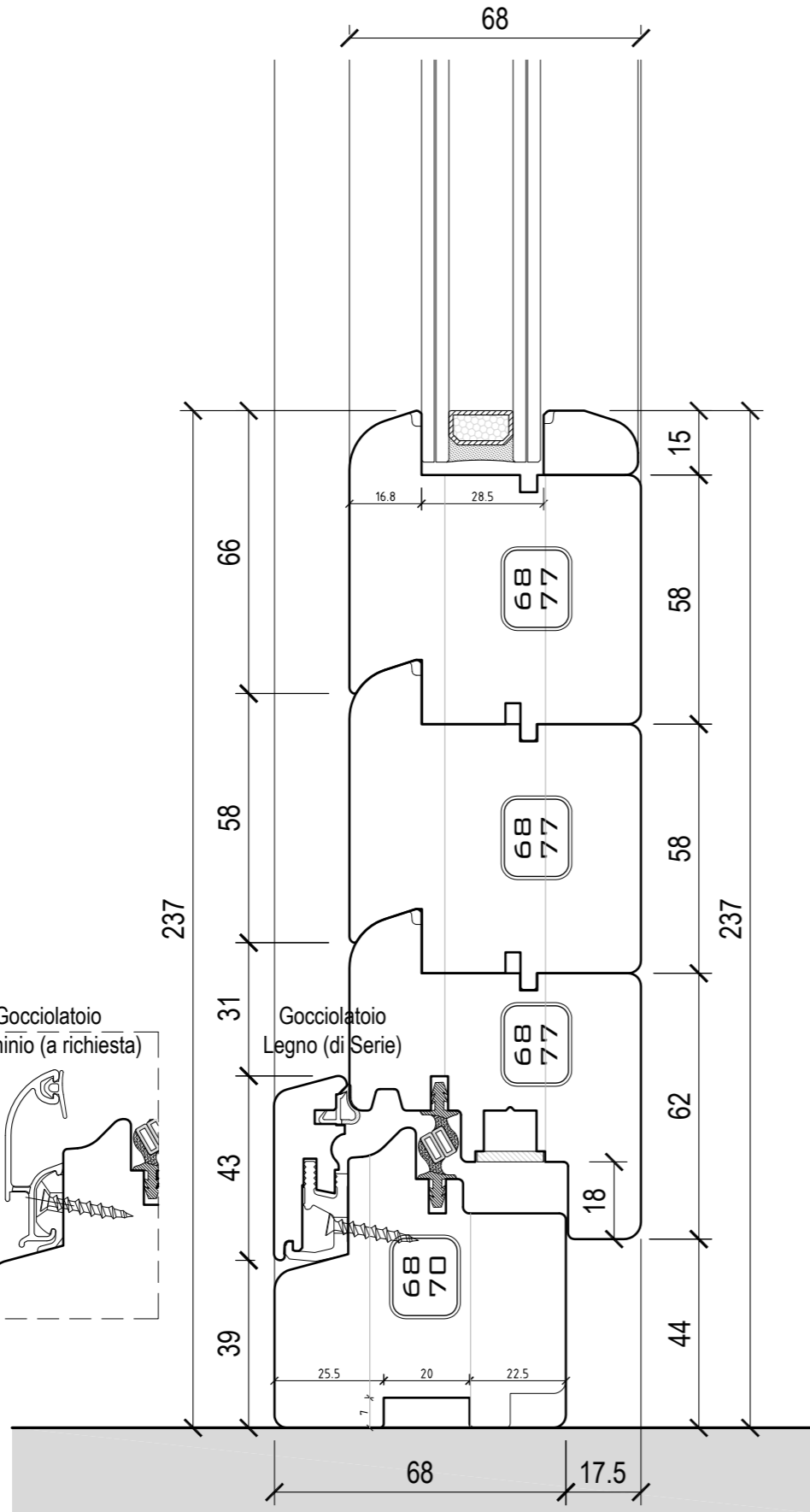
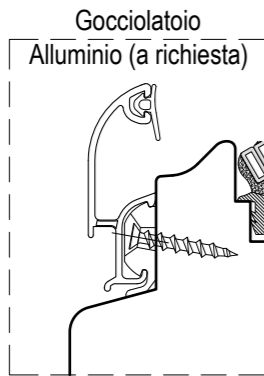
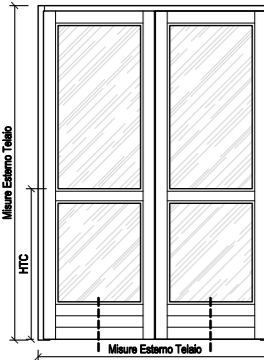

HTC Altezza Traverso Centrale

SCELTA TIPO FERMAVETRO

Fermavetro Sagomato

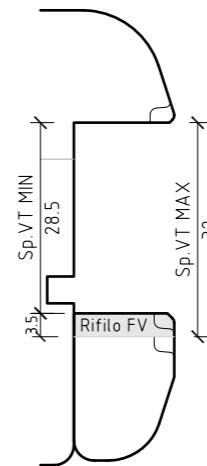

Fermavetro Squadrato

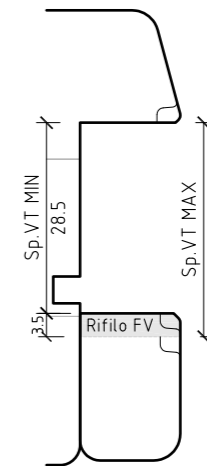

Fermavetro Diamante

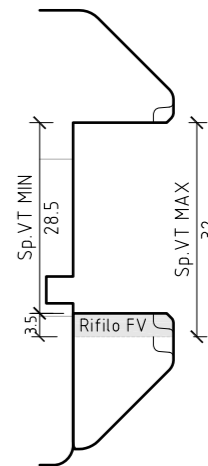

Fermavetro Barocco

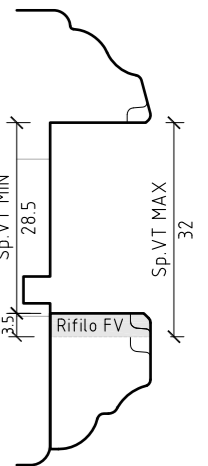

VISTA INTERNA

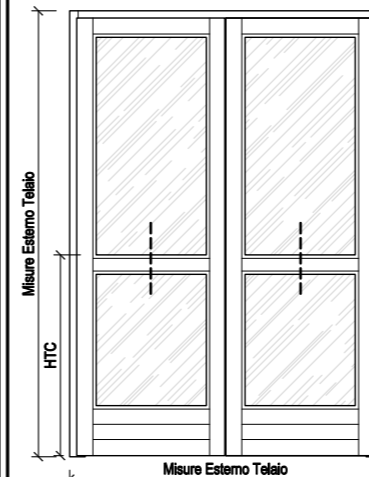

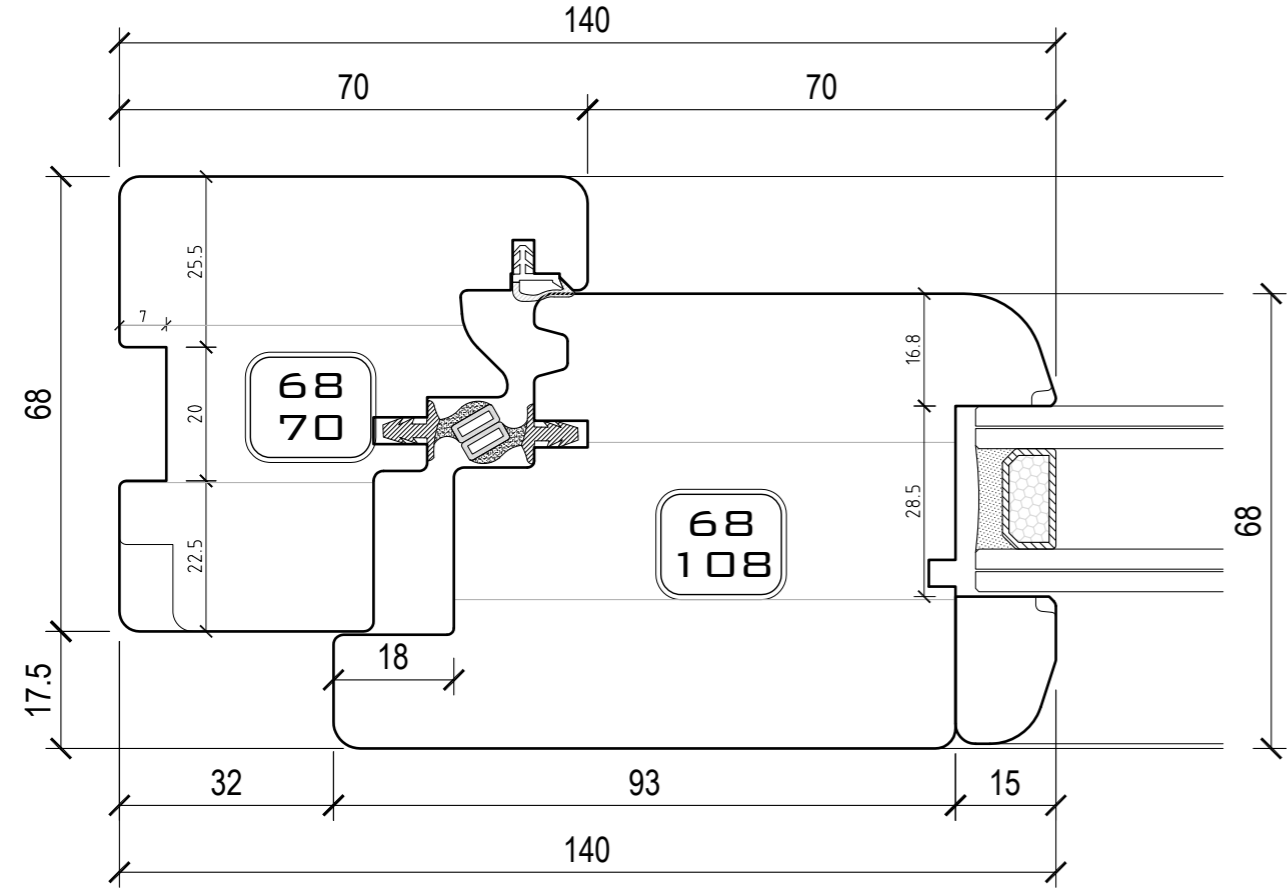

SCELTA TIPO FERMAVETRO

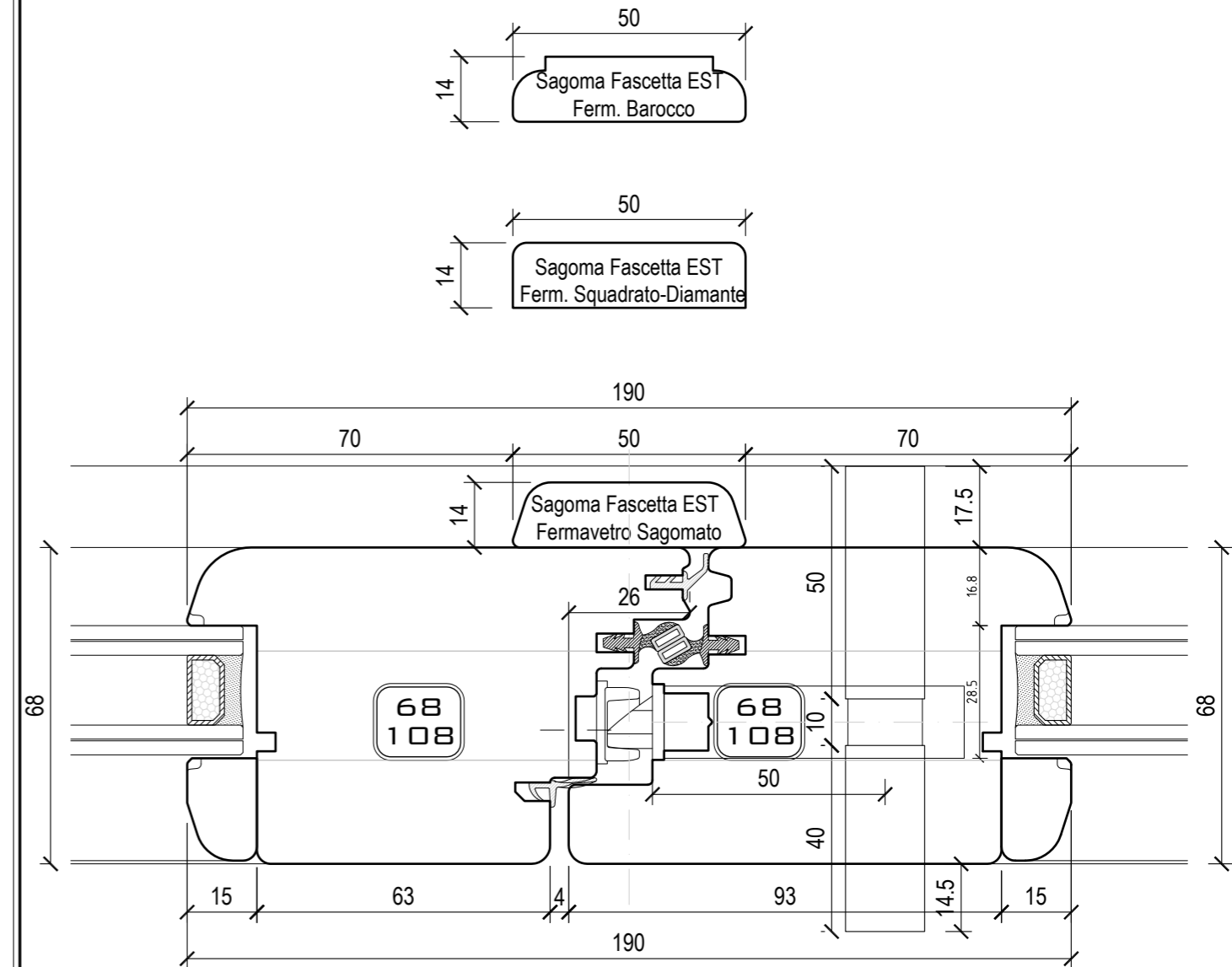
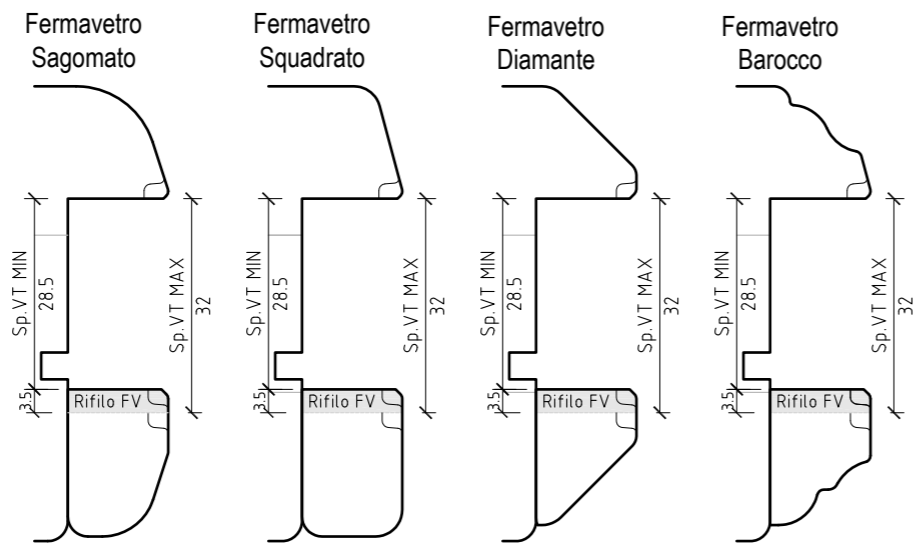
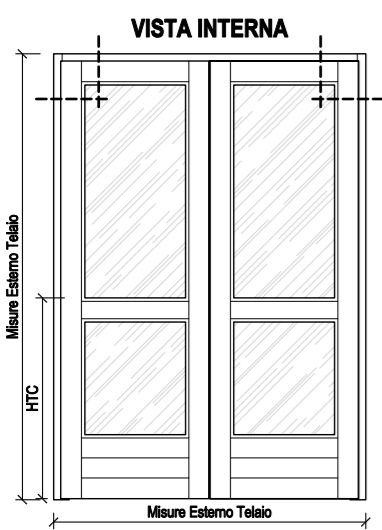

SCELTA TIPO FERMAVETRO

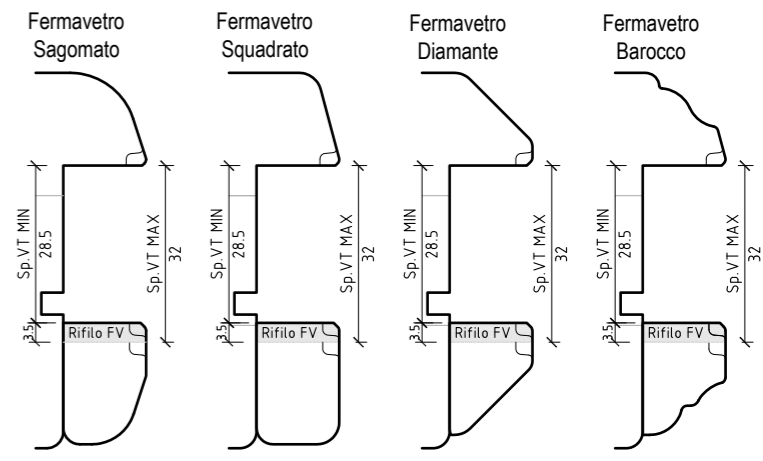
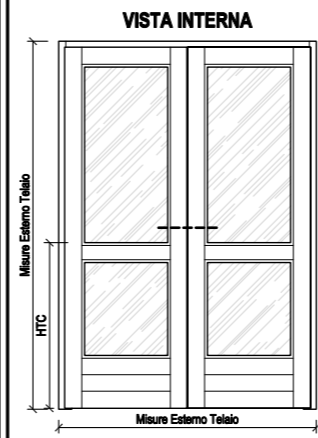

SCELTA
 TIPO FERMAVETRO

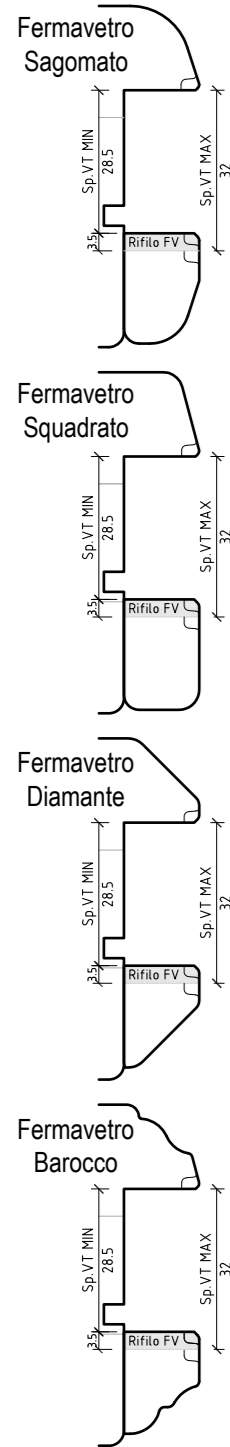

VISTA INTERNA

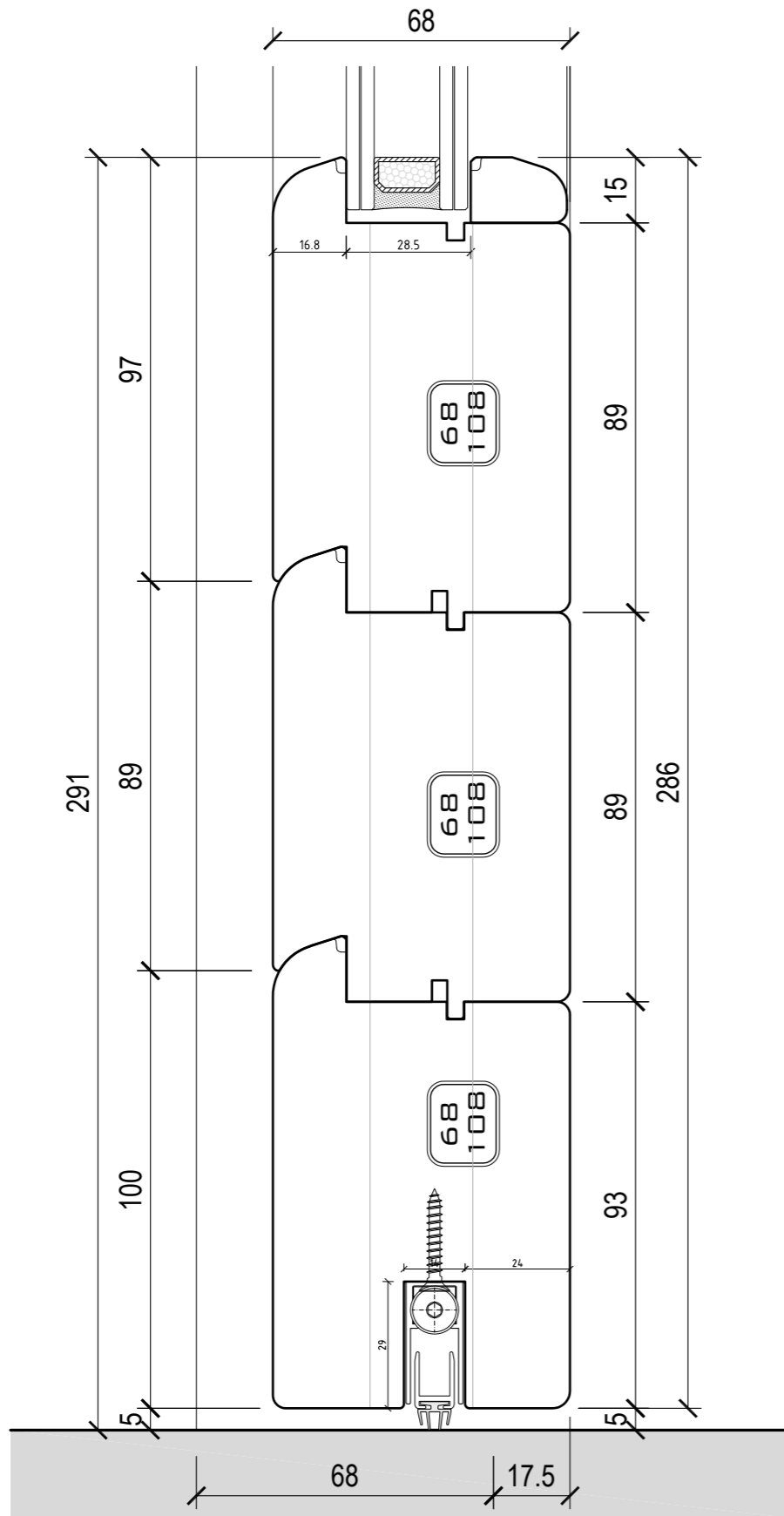
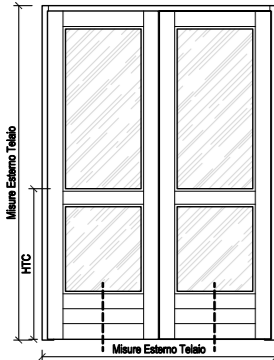

SCELTA
 TIPO FERMAVETRO

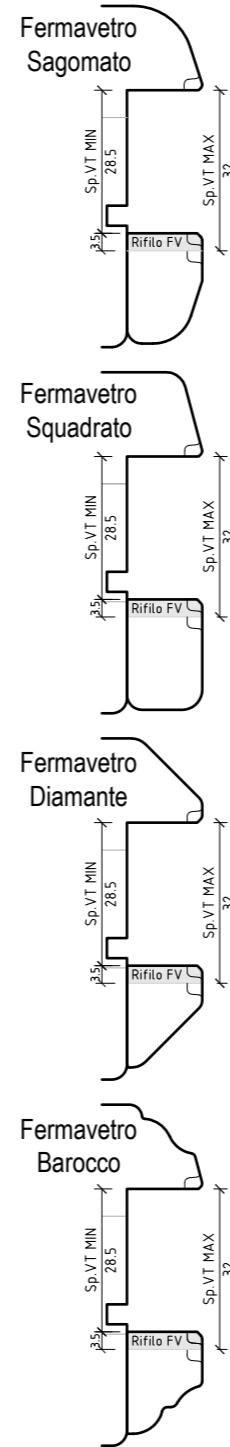

VISTA INTERNA

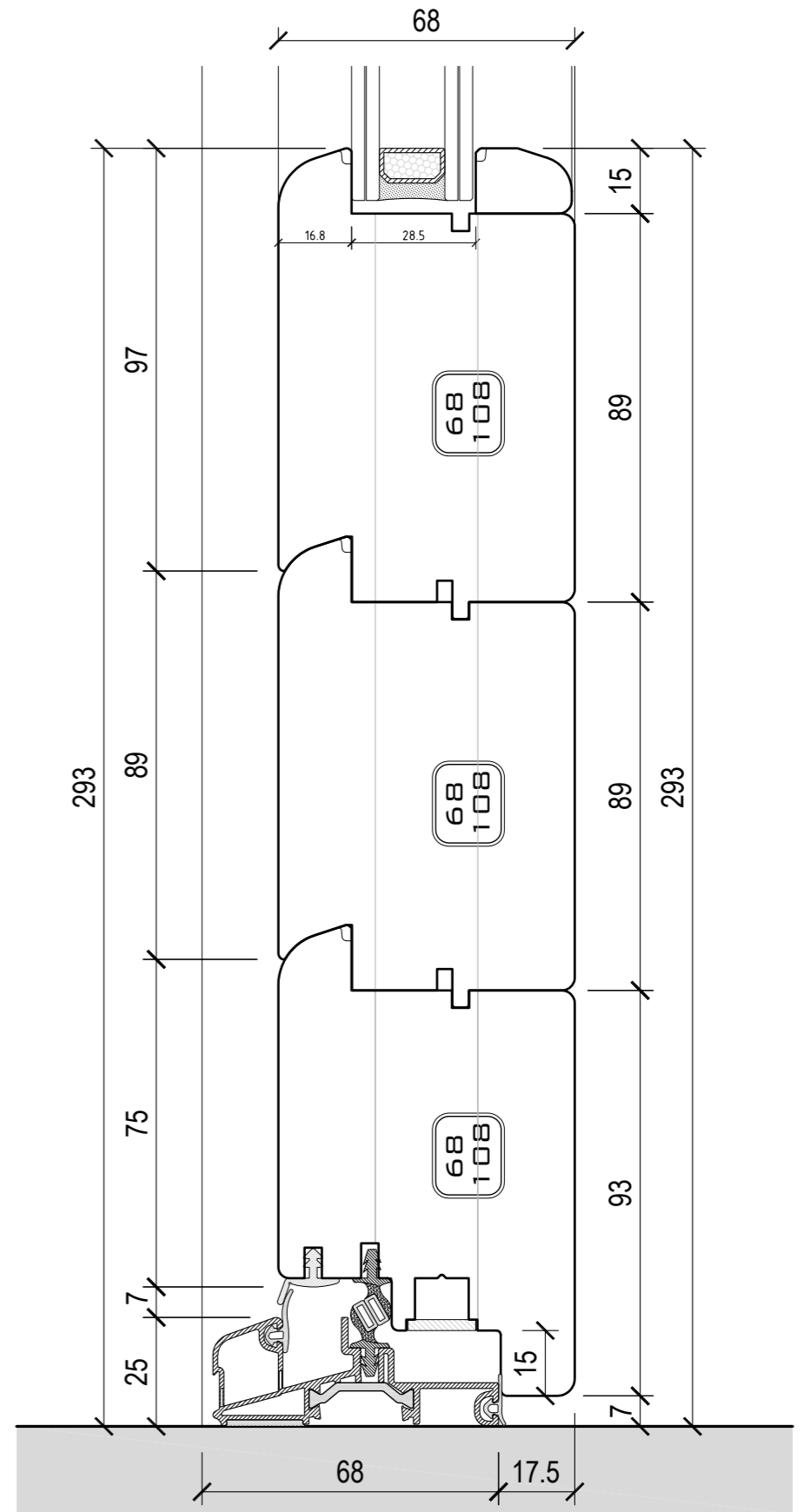
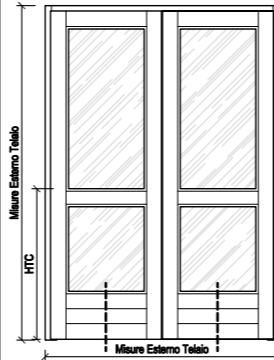

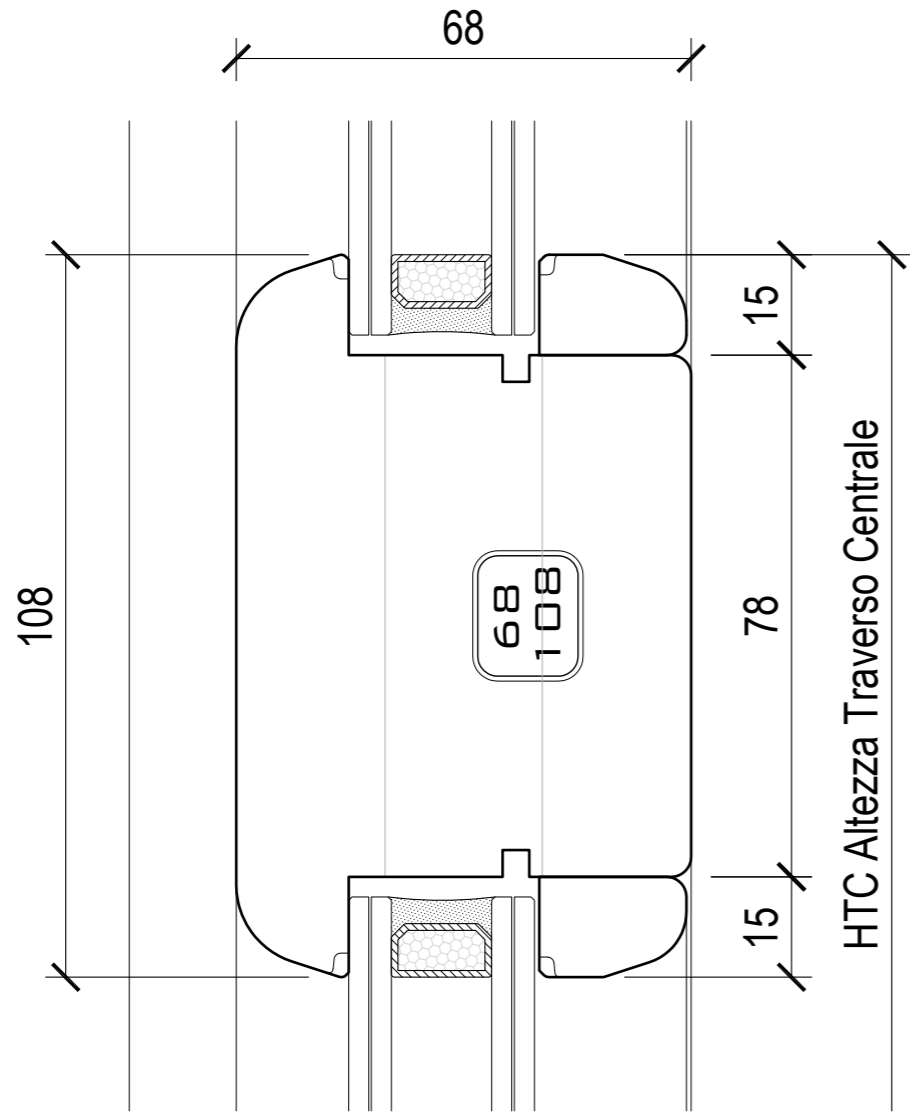

**SCELTA
 TIPO FERMAVETRO**

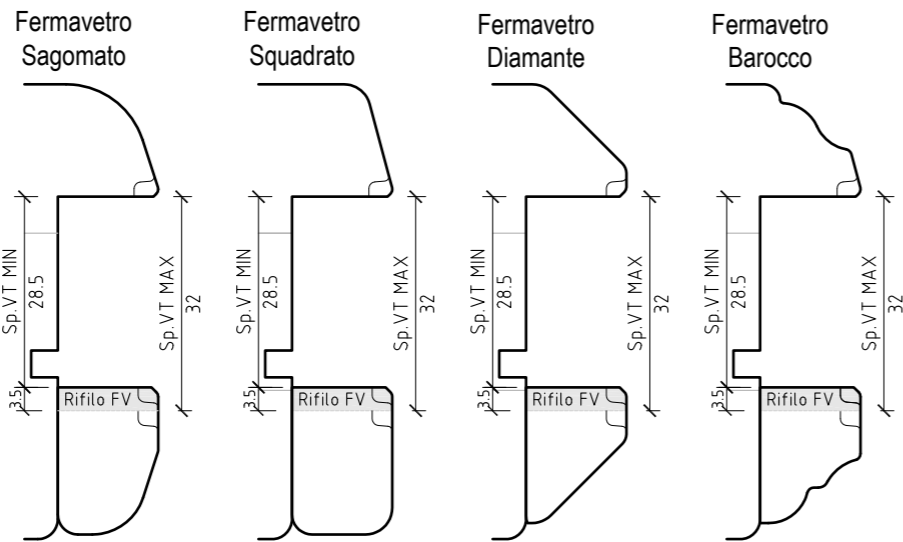

VISTA INTERNA

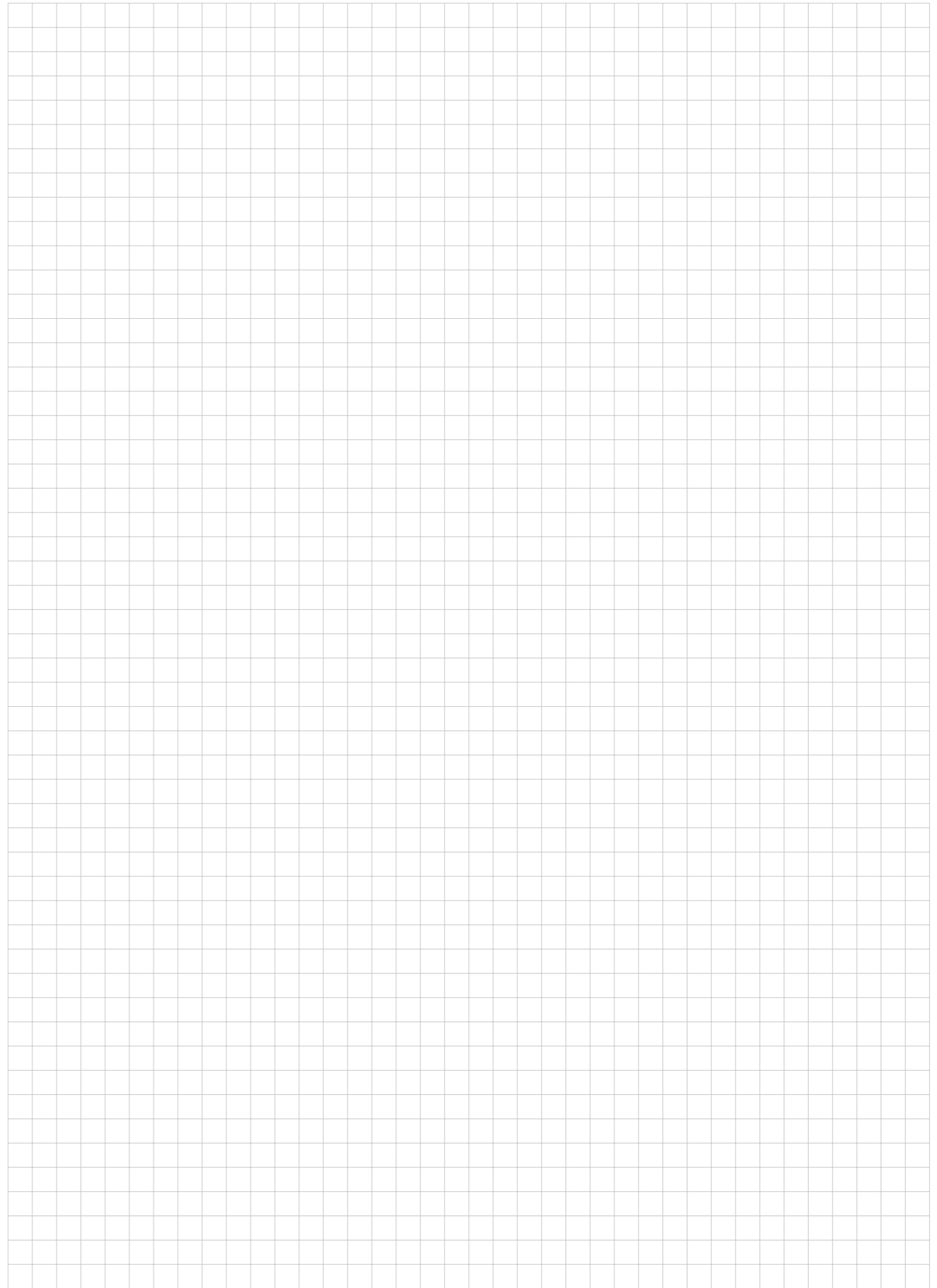
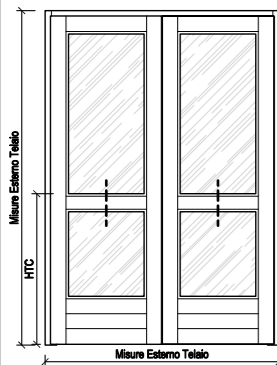

MANUALE
TECNICO

F68M



F I N N O V A

Finnova srl

Via dei Prai 4 M/N

31033 Castelfranco Veneto

Treviso - Italy

T +39 0423 453105

F +39 0423 747287

info@finnovasrl.it

finnovasrl.it

